

M5015 Series

DC BLOWER 50 x 50 x 15 mm



Impeller : Made of plastic PBT UL94 V-0

風 輪: PBT塑料制, 阻燃等级UL94 V-0

Frame : Made of plastic PBT UL94 V-0

扇 框: PBT塑料制, 阻燃等级UL94 V-0

Motor : 4 Poles brushless DC motor

電 機: 4极无刷直流



Model (型号)	Bearing System (轴承)	Rated Voltage (电压) [V]	Voltage Range (电压范围) [V]	Current (电流) [A]	Speed (转速) [RPM]	Maximum Air Flow (风量) [CFM]	Maximum Air Flow (风量) [m³/min]	Max. Static Pressure (静压) [InH2O]	Max. Static Pressure (静压) [Pa]	Noise Level (噪音) [dB-A]	Mass (质量) [g]
M5015LD0	B/S	5	3.6~6.8	0.16	4300	2.87	0.081	0.40	100	35	25
M5015LD1	B/S	12	6.0~13.5	0.09	4300	2.87	0.081	0.40	100	35	25
M5015MD0	B/S	5	3.6~6.8	0.30	4900	3.31	0.093	0.49	122	37	26
M5015MD1	B/S	12	6.0~13.5	0.12	4900	3.31	0.093	0.49	122	37	26
M5015MD2	B/S	24	18.0~26.5	0.07	4900	3.31	0.093	0.49	122	37	26
M5015HD0	B/S	5	3.6~6.8	0.37	5800	3.43	0.097	0.59	147	42.4	27
M5015HD1	B/S	12	6.0~13.5	0.18	5800	3.43	0.097	0.59	147	42.4	27
M5015HD2	B/S	24	18.0~26.5	0.09	5800	3.43	0.097	0.59	147	42.4	27
M5015VD1	B/S	12	6.0~13.5	0.32	6500	3.67	0.104	0.82	204	45	27.5
M5015VD2	B/S	24	18.0~26.5	0.15	6500	3.67	0.104	0.82	204	45	27.5

Dimensions Drawing

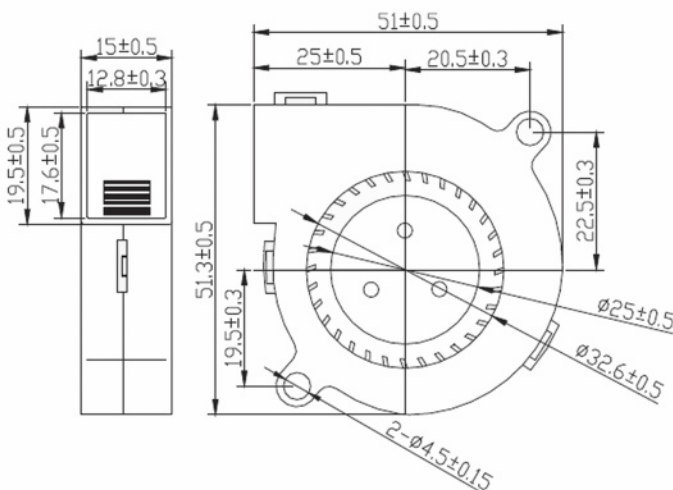

Air Flow & Static Pressure Curve

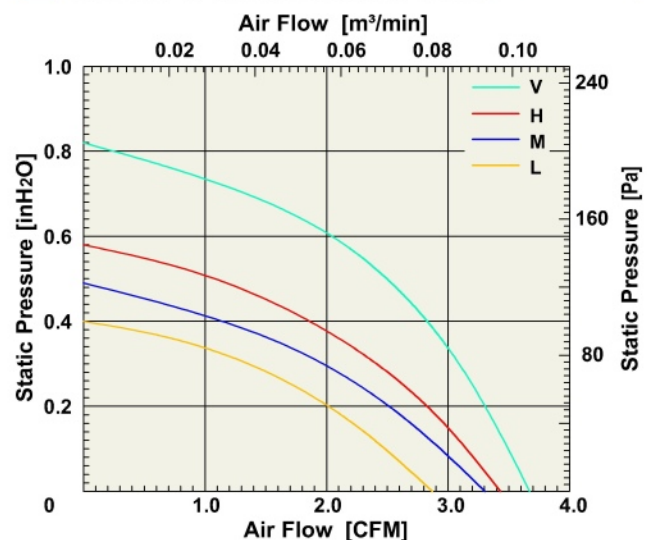

Above specification is only for reference and subject to change without notice.

以上数据仅供参考, 如有变更恕不另行通知。