

M5025
Series

DC BLOWER
50 x 50 x 25 mm

AUTO
RESTART

PWM

FG

RD
SIGNAL H

RD
SIGNAL L



Impeller : Made of plastic PBT UL94 V-0

風 輪: PBT塑料制, 阻燃等级UL94 V-0

Frame : Made of plastic PBT UL94 V-0

扇 框: PBT塑料制, 阻燃等级UL94 V-0

Motor : 4 Poles brushless DC motor

電 機: 4极无刷直流

Model (型号)	Bearing System (轴承)	Rated Voltage (电压) [V]	Voltage Range (电压范围) [V]	Current (电流) [A]	Speed (转速) [RPM]	Maximum Air Flow (风量) [CFM]	Maximum Air Flow (风量) [m³/min]	Max. Static Pressure (静压) [inH ₂ O]	Max. Static Pressure (静压) [Pa]	Noise Level (噪音) [dB-A]	Mass (质量) [g]
M5025LD0	B/S	5	3.6~6.8	0.20	3000	3.1	0.088	0.206	51	34.5	31
M5025LD1	B/S	12	6.0~13.5	0.11	3000	3.1	0.088	0.206	51	34.5	31
M5025MD0	B/S	5	3.6~6.8	0.35	3500	3.73	0.105	0.30	74.7	37.5	32
M5025MD1	B/S	12	6.0~13.5	0.14	3500	3.73	0.105	0.30	74.7	37.5	32
M5025MD2	B/S	24	18.0~26.5	0.08	3500	3.73	0.105	0.30	74.7	37.5	32
M5025HD0	B/S	5	3.6~6.8	0.35	4000	4.0	0.113	0.44	110	40.3	33
M5025HD1	B/S	12	6.0~13.5	0.20	4000	4.0	0.113	0.44	110	40.3	33
M5025HD2	B/S	24	18.0~26.5	0.10	4000	4.0	0.113	0.44	110	40.3	33
M5025VD1	B/S	12	6.0~13.5	0.25	5000	5.3	0.151	0.82	204	46	33
M5025VD2	B/S	24	18.0~26.5	0.12	5000	5.3	0.151	0.82	204	46	33

Dimensions Drawing

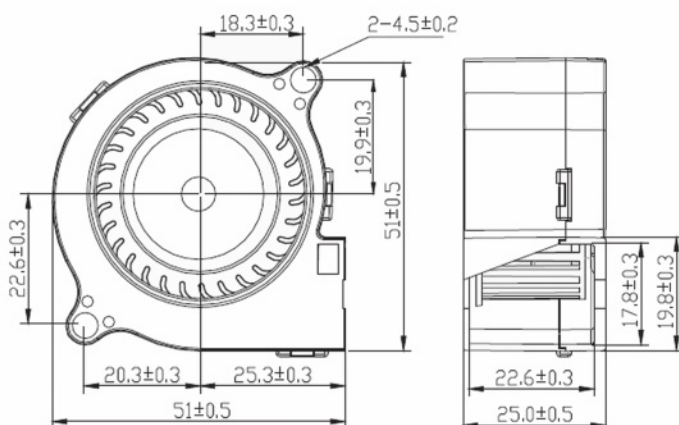

Air Flow and Static Pressure

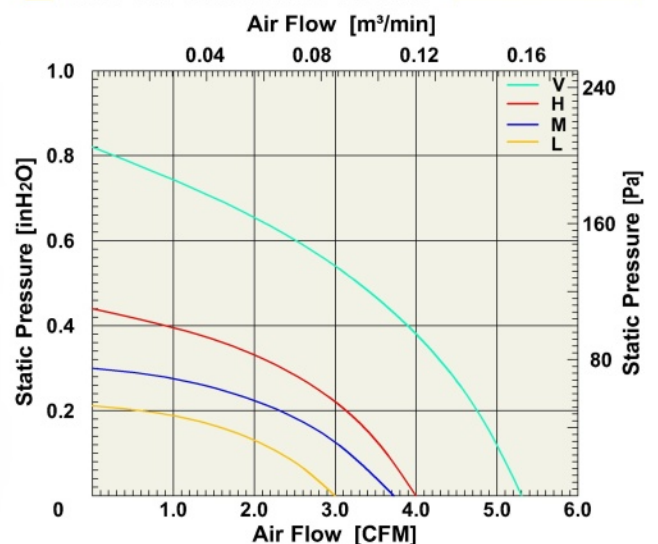

Above specification is only for reference and subject to change without notice.

以上数据仅供参考, 如有变更恕不另行通知。